

## Legendary Reliability with 21st Century Design... It's a WOODMAN!

The P3 continues the Woodman tradition of flexible packaging expertise and legendary reliability. Leveraging more than 60 years experience packaging some of the world's most challenging products, the P3 brings a new level of operator ease of use, speeds, and package size flexibility to applications including: potato chips, tortilla chips, corn chips, pretzels, snack crackers, popcorn and all other salted snacks.

## Investment Savings Through Innovation

The P3 is a "Universal Bagmaker", capable of producing a wide range of bag sizes with consistent performance throughout the range, thanks to its servo motion controls and auto program setup. The P3 offers a variety of bag style options, including block bottom bags, perforated bag string, promotional strip, notching and hole punching.

The P3 features KW's most advanced servo motion control of the film pull belts, end-seal jaws and stripping for quieter, smoother and faster operation than ever before.

The P3's frame is designed for direct mounting of filling systems — reducing the need for a support structure or mezzanine — yet is wide open for access to the interior of the machine. The P3 has a smaller footprint than most bagmakers of its capability thanks to the recessed electrical cabinets.

## Overhead Savings Through Ergonomics and Flexibility

Kliklok-Woodman packaging machines are renowned for their flexibility, easy change-over and maintenance access. The P3's innovations are leading the way for our next generation of bagmakers:



The film supply has been greatly simplified, reducing the downtime spent threading film — and the film unwind is now direct-drive, eliminating secondary braking and providing better performance.



Woodman's proven product clamp and settler ensure that even the trickiest snack foods will be perfectly packaged every time.



The P3's open frame design offers unparalleled maintenance access into the heart of the machine, yet is strong enough to support a filling system.



The electrical enclosure is recessed inside the frame, creating a smaller footprint and adding to the ease of accessibility.



KW's industry-leading Insight® color touch screen HMI is intuitive and self tutoring. Enhanced diagnostics are standard on the P3. Networking and remote connectivity options are available.

## PERFORMANCE

**SPEED:** Variable from 10 to 100 bags per minute

*Actual speed depends upon product characteristics, bag size, packaging material and filling system.*

**BAG SIZE RANGE: MIN. MAX.**

**Width** 63 mm (2.5") 305 mm (12")

**Length** 76 mm (3") 559 mm (22")

**BAG STYLES:** Pillow Pouch (fin or lap seal), Flat/Block Bottom, Gusseted, Stand-up Pouch Bag Format

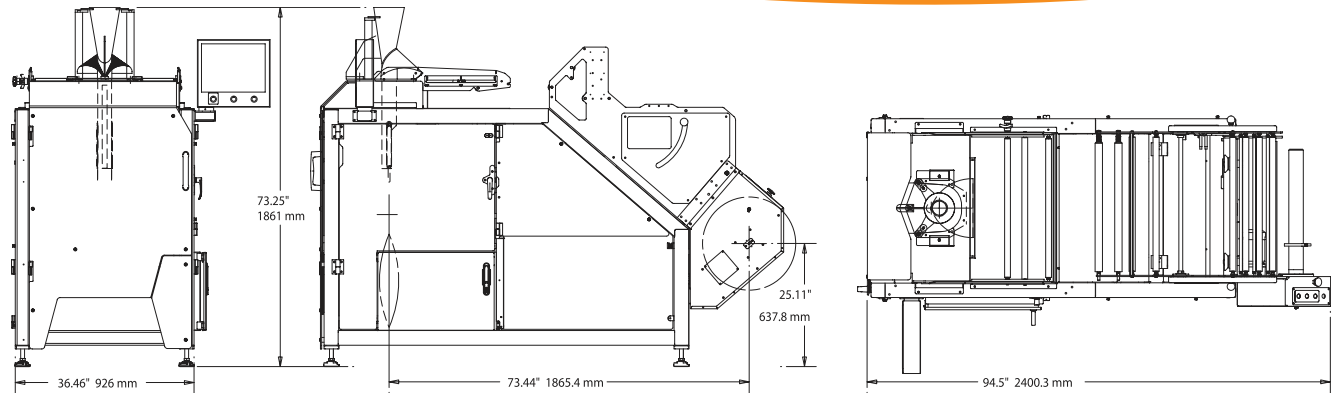

## OPERATING REQUIREMENTS

**ELECTRICAL:** 480 VAC  $\pm 5\%$ , 3-Phase with ground (PE), 50/60 Hz, 7kVA (7kW) service required

*Electrical system conforms to Safety and Code of Compliance Editions of HSWA, IEC (ENC60204) and NFPA 79. CE/UL approved. System meets Category 3 safety requirements.*

**AVERAGE AIR CONSUMPTION:** 43 L/min (1.5 CFM) at 4.8 bar (70 psi) for 100 bpm

**ENVIRONMENT:** Normal ambient temp. 10–38°C (50–100°F), less than 90% non-condensing humidity.

**FILM CORE INSIDE DIAMETER:** 76mm (3")

**Max. FILM ROLL OUTSIDE DIAMETER:** 508 mm (20")

**Max. FILM ROLL WEIGHT:** 34 kg (75 lbs)

## CONSTRUCTION

Welded tubular stainless-steel-powder-coated steel frame with hard-anodized aluminum parts.

Approximate weight: 1273 kg (2800 lb)

## STANDARD FEATURES

- Servo motor-controlled: film pull belts, jaw seal actuation and reciprocating carriage with programmable stripping motion
- Cantilevered film spindle with direct-drive unwind
- Quick-Set self-adjusting pressure-controlled seam seal
- Simple easy-threading film handling
- Electronic registration control
- Product clamp and settler
- Sealing jaws with Heat Pipe technology
- Insight® Color Touch Screen HMI with performance reporting, diagnostics and troubleshooting
- Automatic program setup
- Instant program changeover
- "Off the shelf" non-proprietary control components
- Recessed electrical panels
- Ancillary device isolated interface strip
- 110-volt convenience outlet and data port
- Full safety guarding and interlocks
- End-of-film control with low-level film alarm

## OPTIONAL FEATURES

- Direct-to-frame weigher/filling device support
- Film splice assist
- Woodman Codeline code dater
- Automatic film tracking
- Quick-change ultralight former assembly
- Programmed nitrogen flush
- High-speed product pocker on former assembly
- Vacuum pull assist for high-slip materials
- Quick-change jaws
- Hole-punch jaws
- Easy-tear notcher
- Perforated bag strip
- Special end seal configurations
- Flat/Block-bottom bag sealing system
- Stand-up pouch bag format
- Promotional strip
- Display strip
- Network connectivity
- Web browser for single point control