

Legendary Reliability with 21st Century Design... It's a WOODMAN!

The **P3c Constant Motion Bagmaker** continues the Woodman tradition of flexible packaging expertise and legendary reliability. Leveraging more than 60 years experience packaging some of the world's most challenging products, the P3c brings a new level of operator ease of use, speeds, and package size flexibility to applications including: potato chips, tortilla chips, corn chips, pretzels, snack crackers, popcorn and all other salted and savory snacks.

Investment Savings Through Innovation

The P3c is a "Universal Bagmaker," capable of producing a wide range of bag sizes with consistent performance throughout the range, thanks to its servo motion controls and auto program setup. The P3c offers a variety of bag style options, including block bottom bags, perforated bag string, promotional strip, notching and hole punching.

The P3c features KW's most advanced servo motion control of the film pull belts, end-seal jaws and stripping for quieter, smoother and faster operation than ever before — with production speeds up to 120 bpm.

The P3c's frame is designed for direct mounting of filling systems — reducing the need for a support structure or mezzanine — yet is wide open for access to the interior of the machine. The P3c has a smaller footprint than most bagmakers of its capability thanks to the recessed electrical cabinets.

Overhead Savings Through Ergonomics and Flexibility

Kliklok-Woodman packaging machines are renowned for their flexibility, fast change-over and easy, low-cost maintenance. The P3c's innovations are leading the way for our next generation of bagmakers:

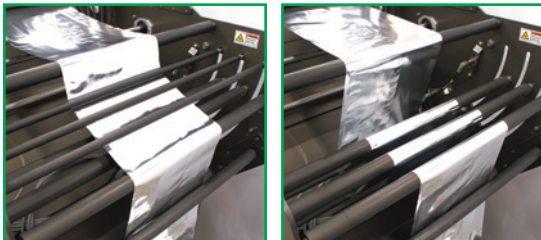

The film supply has been greatly simplified, reducing the downtime spent threading film — and the film unwind is now direct-drive, eliminating secondary braking and providing better performance.



Woodman's proven product clamp and settler ensure that even the toughest snack foods will be perfectly packaged every time.



The P3c's open frame design offers unparalleled maintenance access into the heart of the machine, yet is strong enough to support a filling system.



The electrical enclosure is recessed inside the frame, creating a smaller footprint and adding to the ease of accessibility.



KW's industry-leading Insight® color touch screen HMI is intuitive and self tutoring. Enhanced diagnostics are standard on the P3c. Networking and remote connectivity options are available.

PERFORMANCE

SPEED: Variable from 10 to 120 bags per minute

Actual speed depends upon product characteristics, bag size, packaging material and filling system.

BAG SIZE RANGE: MIN. MAX.

Width 63 mm (2.5") 305 mm (12")

Length 76 mm (3") 559 mm (22")

BAG STYLES: Pillow Pouch (fin or lap seal), Flat/Block Bottom, Gusseted, Stand-up Pouch

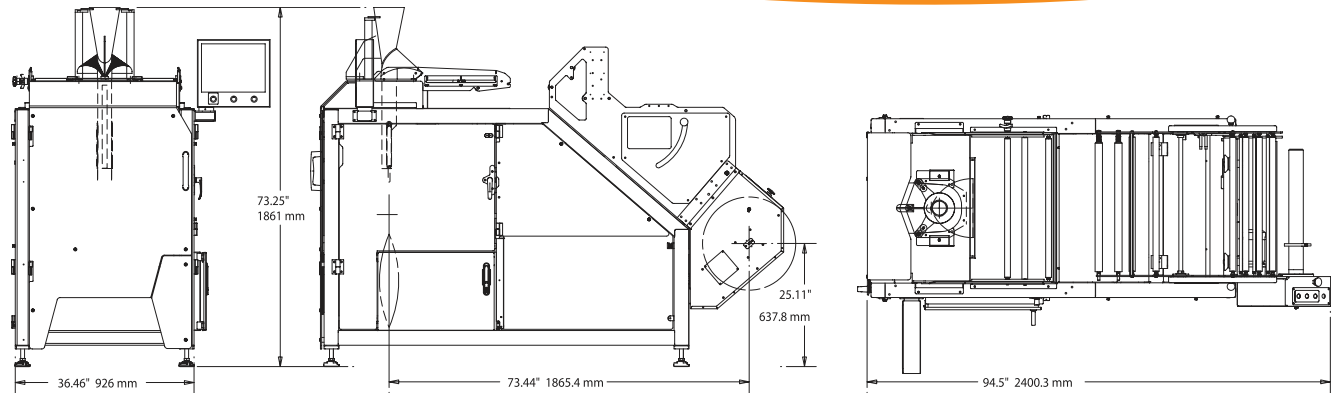

OPERATING REQUIREMENTS

ELECTRICAL: 480 VAC \pm 5%, 3-Phase with ground (PE), 50/60 Hz, 7kVA (7kW) service required

Electrical system conforms to Safety and Code of Compliance Editions of HSWA, IEC (ENC60204) and NFPA 79. CE/UL approved. System meets Category 3 safety requirements.

AVERAGE AIR CONSUMPTION: 43 L/min (1.5 CFM) at 4.8 bar (70 psi) for 100 bpm

ENVIRONMENT: Normal ambient temp. 10–38°C (50–100°F), less than 90% non-condensing humidity.

FILM CORE INSIDE DIAMETER: 76mm (3")

Max. FILM ROLL OUTSIDE DIAMETER: 508 mm (20")

Max. FILM ROLL WEIGHT: 34 kg (75 lbs)

CONSTRUCTION

Welded tubular stainless-steel-powder-coated steel frame with hard-anodized aluminum parts.

Approximate weight: 1273 kg (2800 lb)

STANDARD FEATURES

- Optimizes Motion Profiles In One Machine (CM or IM)
- Space Saving Open Tubular Frame Design
- Full Servo Motion Control
- Sealing Jaws with Heat Pipe Technology for Improved Temperature Distribution
- Exclusive Film Motion Driven Rotary Seam Seal Bar
- Insight® HMI Color Touch-Screen
- "Off The Shelf" Non-Proprietary Control Components
- Automatic Program Set-Up
- Instant Program Changeover
- Electronic Registration Control
- Full Safety Guarding and Interlocks
- 110-Volt Convenience Outlet and Data Port
- Ancillary Device Isolated Interface Strip
- CE/ETL Approved Electricals Meets Category 3 Safety Requirements
- "In Frame" Electrical Panel Reduces Footprint
- Quick Change Former Assembly with Improved Product Transfer
- Able to Accept Existing Woodman Polaris Formers
- NEW Simple, Easy Threading Film Handling
- Cantilevered Film Supply Spindle with Direct Drive Unwind
- End of Film Sensor

OPTIONAL FEATURES

- Direct-to-Frame Weigher / Filling Device Support
- High Speed Product Poker on Former Assembly
- Frame Mounted Poker for Woodman Gemini Formers
- Integrated Woodman **Codeline** by Videojet TTO Printer
- Code Date Integration and Print Register Kits
- Fully Integrated Auto Track
- Splice Assist
- Vacuum Belt Assist for High-Slip Materials
- Quick Change Jaws
- Hole-Punch Jaws
- Easy Tear Notcher
- Flat Bottom / Block Bottom Bag Format
- Stand-Up Pouch Bag Format
- Programmed Nitrogen Flush
- Perforated Bag Strip
- Promotional Strip
- Bag Grouping
- Ethernet/ Modem Networking Connectivity
- Web Browser for Single Point Control